

# BUNN®

## JDF-2S & JDF-4S LED Door Conversion Kits 42528.0001 & 42529.0001

### LED Conversion Kit Instructions for JDF-S and JDF-4S

1. Disconnect the power from the machine before beginning the conversion.
  2. Remove door cover by taking out the 5 screws and unplugging the dispense switch harness from the door harness. Set door cover and screws aside.
  3. Disconnect the 3-pin connector from the ballast to the door harness.
  4. Remove the entire light panel assembly from the foam door by removing the 4 screws.
- Note:** If machine is Portion Control, remove small board from the old light panel assembly and re-install on new light panel assembly.
5. Attach new light panel assembly using the existing 4 screws.
  6. Connect 3-pin connector on new light assembly to the existing door harness.
  7. To replace door cover, re-connect the dispense switch harness to the door harness.
  8. Fasten the 5 screws to the door cover.
  9. Re-apply power to the unit.

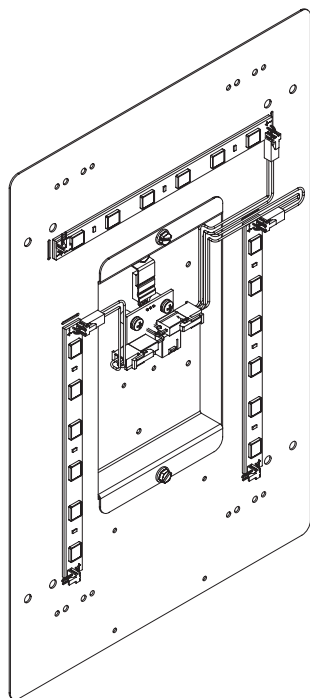

JDF-2S

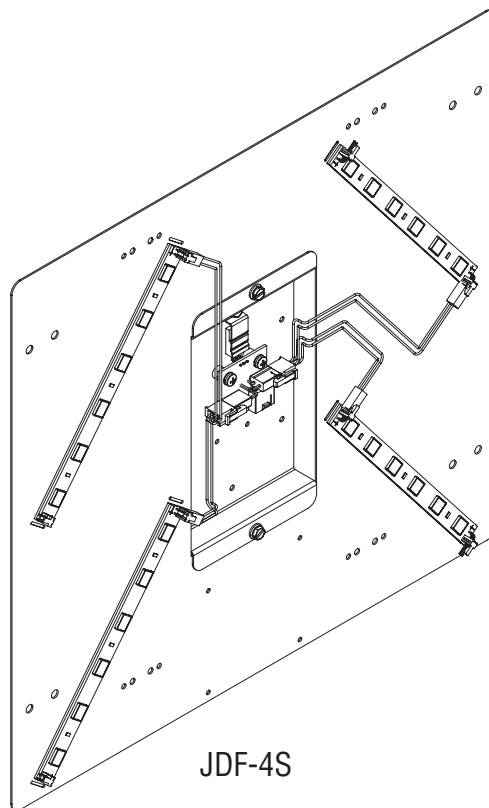

JDF-4S

(Continued)

### BUNN-O-MATIC CORPORATION

POST OFFICE BOX 3227  
SPRINGFIELD, ILLINOIS 62708-3227

PHONE: (217) 529-6601 FAX: (217) 529-6644



## JDF-2S Shown

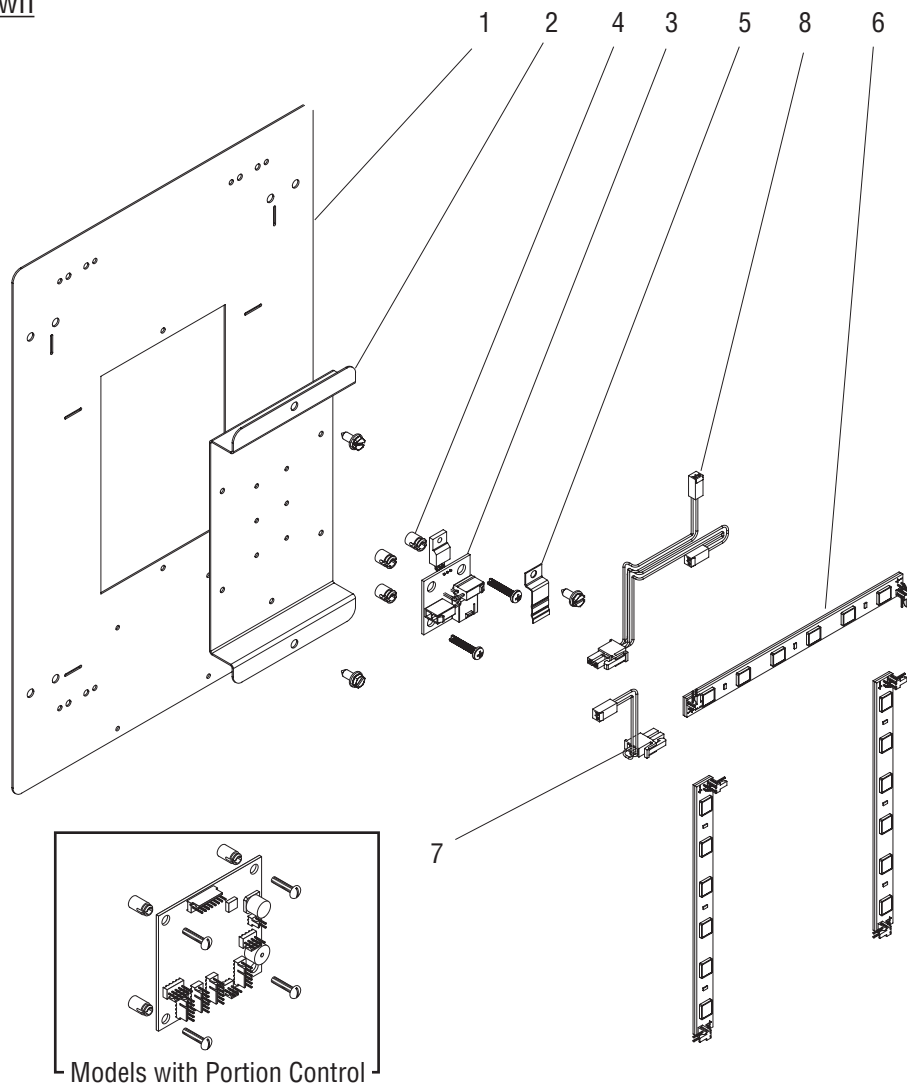

## LED DOOR PANEL ASSEMBLY

ITEM	PART NO.	QTY.	DESCRIPTION
-	42528.0001	1 -	Door Panel Kit, JDF-2S (Includes items 1 - 8)
	42529.0001	- 1	Door Panel Kit, JDF-4S (Includes items 1 - 8)
1	39721.0001	1 -	Door Panel, JDF-2S
	39724.0001	- 1	Door Panel, JDF-4S
2	40159.0001	1 1	Bracket, Transformer Mounting
	02335.0001	2 2	Screw, Crimpite #8 x .38"
3	41727.0000	1 1	Circuit Board
	14002.6300	3 3	Screw, Pan Head #6-20 x .75"
4	29081.0005	3 3	Spacer
5	41244.0000	1 1	Clip, Spring
6	42593.0000	3 4	LED Light Assy
7	42609.0000	1 -	Wiring Harness LED to CB
8	42609.0001	1 2	Wiring Harness LED to CB