



JDF-2S, JDF-4S Ballast Replacement Instructions

The following instructions are to be followed when replacing a dual ballast (40307.0001) assembly with a single ballast (40307.0000) assembly.

1. Disconnect the power from the machine before any service.
2. Remove door cover by taking out the 5 screws and unplug the dispense switch harness from the door harness. Set door cover and screws aside.
3. Disconnect the 3-pin connector from the ballasts to the door harness.
4. Remove fluorescent bulbs from the brackets. Pull off the four snap-in light sockets from the light panel.
5. Remove the wire to the ballast from the back of each bracket.
 - a. To disengage the ballast wire from the bracket, push a 1/16" allen wrench (or equivalent tool) into the front hole that lines up with the wire in the back. Pull the wire out.
 - b. Repeat for each bracket.
 - c. White jumper must remain in place on the back of the light socket.
6. Remove screws from each ballast. Remove the green ground wire from the ballast bracket by removing the bracket's bottom screw.
7. Install the single ballast (wires on the bottom) onto the ballast bracket using 2 of the screws previously removed.
8. Attach ballast wires to the back of bulb sockets by pushing wires into holes in back of socket.

Note: Attach black wires to the top sockets, and blue wires to the bottom sockets. Reference electrical schematic in operation manual or on back of splash panel if needed.

9. Snap all 4 bulb sockets back onto light panel. Reinstall fluorescent bulbs.
10. Attach green ground wire to the bottom hole of the ballast bracket using 1 screw.
11. Plug in 3-pin connector into the door harness.
12. To replace door cover, re-connect the dispense switch harness to door harness. Fasten with 5 screws.
13. Re-apply power to the unit. Test operation.

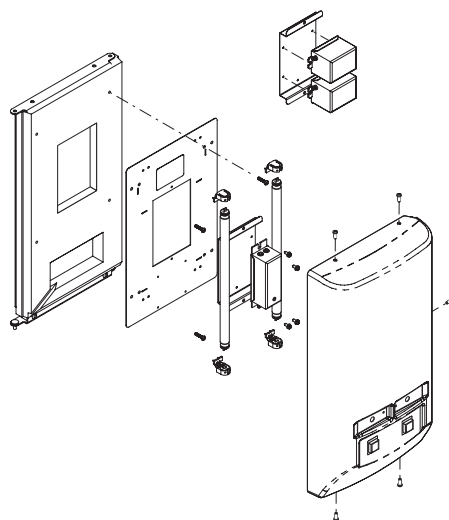

BUNN-O-MATIC CORPORATION

POST OFFICE BOX 3227

SPRINGFIELD, ILLINOIS 62708-3227

PHONE: (217) 529-6601 FAX: (217) 529-6644

