

BUNN®

AXIOM/CDBC & INFUSION SERIES FAUCET TUBING KIT

INTRODUCTION

This kit will replace the tubing and reducer for the hot water faucet.

KIT CONTENTS

1. 2 Clamps
2. 1 Long Silicone Tube
3. 1 Short Silicone Tube
4. 1 Instruction Sheet

INSTRUCTIONS

WARNING – UNPLUG THE BREWER AND ALLOW TO COOL BEFORE PROCEEDING.

Refer to illustration

1. Remove top and front covers.
2. Drain tank till water level is below faucet outlet.
3. Remove old faucet tubing.
4. Slip the short tube (3) over the back of the faucet shank (4).
5. Slip the long tube (2) over the short tube (3) as shown. NOTE: Lubricating with a little water or alcohol may be necessary to facilitate tube installation. DO NOT USE OIL OR GREASE!
6. Install one of the new clamps (1) over both tubes as shown and hand tighten.
7. Install remaining end of long tube and second clamp over tank outlet.
8. Connect brewer to power source and allow to refill, check for leaks.
9. Reinstall covers.

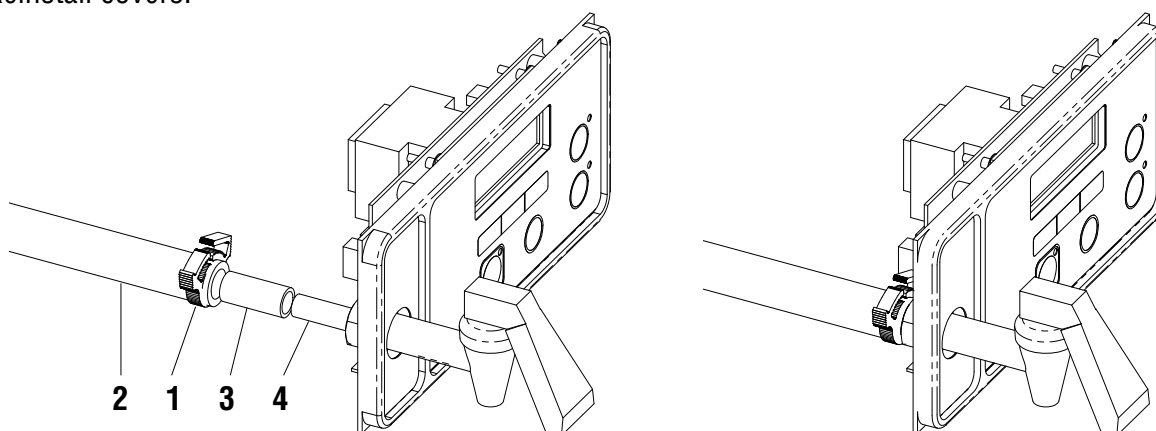

BUNN-O-MATIC CORPORATION

POST OFFICE BOX 3227

SPRINGFIELD, ILLINOIS 62708-3227

PHONE: (217) 529-6601 FAX: (217) 529-6644

