



DUAL SH DBC/ SINGLE SH DBC

FAUCET REMOVAL INSTRUCTIONS

INTRODUCTION

This kit is intended for use on all DUAL SH DBC® and SINGLE SH DBC® models with the Hi-Lime tank. The upper hot water faucet on the brewers can be removed using this kit.

KIT CONTENTS

ITEM	PART NO.	QTY.	DESCRIPTION
1	12422.0001	1	Clamp, Hose-Snap Type
2	05749.0004	1	Plug, Hole Black .50"
3	29279.0000	1	Cap, Tube-Silicone

INSTRUCTIONS

FAUCET REMOVAL MUST BE PERFORMED BY AUTHORIZED SERVICE PERSONNEL ONLY!

WARNING: Disconnect brewer from power source before the removal of any panel or replacement of any component.

WARNING: Water drained from the brewer and many internal parts are extremely hot; allow contents of tank to cool before proceeding.

1. Remove the front access panel and top cover to gain access to the drain tube and faucet tube. (FIG. 1)
2. Locate the end of the drain tube hose in the base of the brewer and pull it out. (FIG. 2)

NOTE: If the brewer has been in service, the tank must be drained before proceeding.

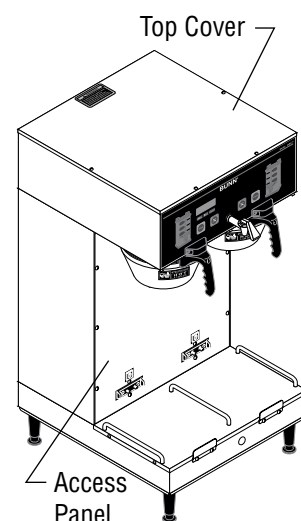

FIG 1

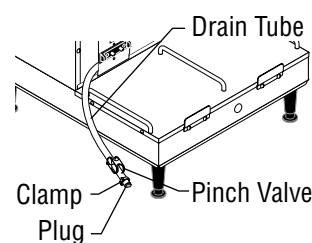

FIG 2

BUNN-O-MATIC CORPORATION

POST OFFICE BOX 3227
SPRINGFIELD, ILLINOIS 62708-3227
PHONE: (217) 529-6601 FAX: (217) 529-6644



CAUTION: Drain the tank using the drain tube. To avoid tank refill, ensure the water inlet valve is closed when the drain tube plug is removed and power has been disconnected from the brewer.

3. Remove the clamp and plug from the drain tube and release the pinch valve. (FIG. 2)
4. Drain enough water from the tank so the water level inside the tank is below the faucet outlet and/or By-Pass Valve(s).
5. Depending on the model being modified, removal of the overflow cup may facilitate this procedure. If necessary, remove the two nuts holding the overflow cup in place and move the cup out of the way. (FIG. 3)
6. Remove the existing water faucet tube and clamps from the brewer and discard. (FIG. 4)
7. While holding the faucet body on the outside of the brewer, loosen and remove the jam nut from the inside of the brewer. (FIG. 4)
8. Remove the faucet from the brewer. (FIG. 4)
9. Install the hole plug, provided with this kit, into the faucet mounting hole in the hood. (Where the faucet was removed.)
10. Install the silicone cap on the tank fitting and use the snap type clamp provided to clamp the cap to the fitting. (FIG. 5)
11. If removed, reinstall the overflow cup.
12. Verify the drain tube plug and hose clamp are installed in the end of the drain tube.
13. Ensure the pinch valve is installed on the drain tube and that it is closed.
14. Place the clamped end of the drain tube into the bottom of the brewer.
15. Turn on the water inlet valve and check the new connections for leaks.
16. Reinstall the front access panel and top cover.
17. Plug in the brewer and allow it to reheat.

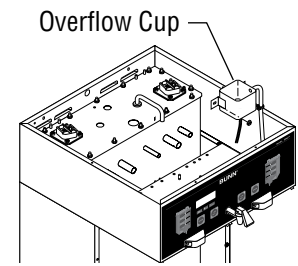

FIG 3

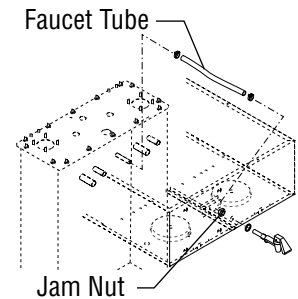

FIG 4

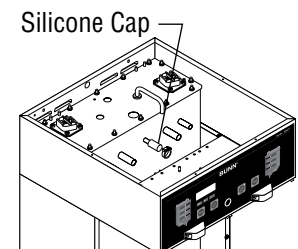

FIG 5